

FULL ECONOMIC COSTING AND ESTATES

11/13th December 2006



University of St Andrews

Full Economic Costing (fEC)

- Move to sustainability
- fEC as a logical development of TRAC
- Differences between costing and pricing
- Successfully introduced from 1st September 2005



Main Changes With fEC

- Costs of PI's now recoverable
- Specified cost for use of Estates
- Specified cost for other indirect costs
 - Finance, IT Services, Library



Sponsors and fEC

- All applications are costed under fEC regime
 - research councils – 80%
 - government departments – 80/100%
 - charities – will not pay overhead, 100% directly incurred
 - EU – not at present – possibly FP7
 - commercial/industrial/other – negotiable



fEC Categories

- Directly Incurred Costs
- Directly Allocated Costs
- Indirect Costs
- Exceptional Costs



Directly Incurred (DI)

- Salaries
 - leading to FTE's involved in project
- Consumables
- Travel
- Small equipment
- Subscriptions
- Books, etc
- Items with an audit trail linked to the project



Indirect / Exceptional

- Indirect costs
- Exceptional items (100%) fEC
 - equipment over £50k
 - project studentships



Directly Allocated (DA)

- Shared time
 - PI, clerical, technician
- Shared facilities
 - equipment, animal house etc
- Estates costs



Indirect/Estates

- Indirect cost (06/07 - £38,053) / project FTE pa
- Estates Rates
 - laboratory rate (06/07 - £8,135) / project FTE pa
 - non-laboratory rate (06/07- £6,542) / project FTE pa
- Recalculated Annually



Estates Costs

- Simplified Method Available to August 2007
- Robust method of Calculation thereafter
- More developed Calculation taking into account type of space and cost



ROOM USAGE

- Teaching – Category T
- Research – Category R
- Both teaching And Research Category B
- Other



Space Categories

- CAT1 - Shed/File Room/Rock Store
- CAT2 – Office/Lecture Hall/Seminar Room
- CAT3 – Lab/Computer Lab
- CAT4 – High Spec Lab/Specialised Unit



Calculation

- Verification of Square Metres by Category
- Average Weighted Cost per Cost Element
- Total Estate cost per Sq Metre for different Space Categories.
- Average Sq Metre per FTE



PRACTICAL DETAILS

- Snapshot as at 31st July 2006
- Net Usable Space
- Help with Completion
- Building split into more than one School
- Building Code eg, 40SCBIOL



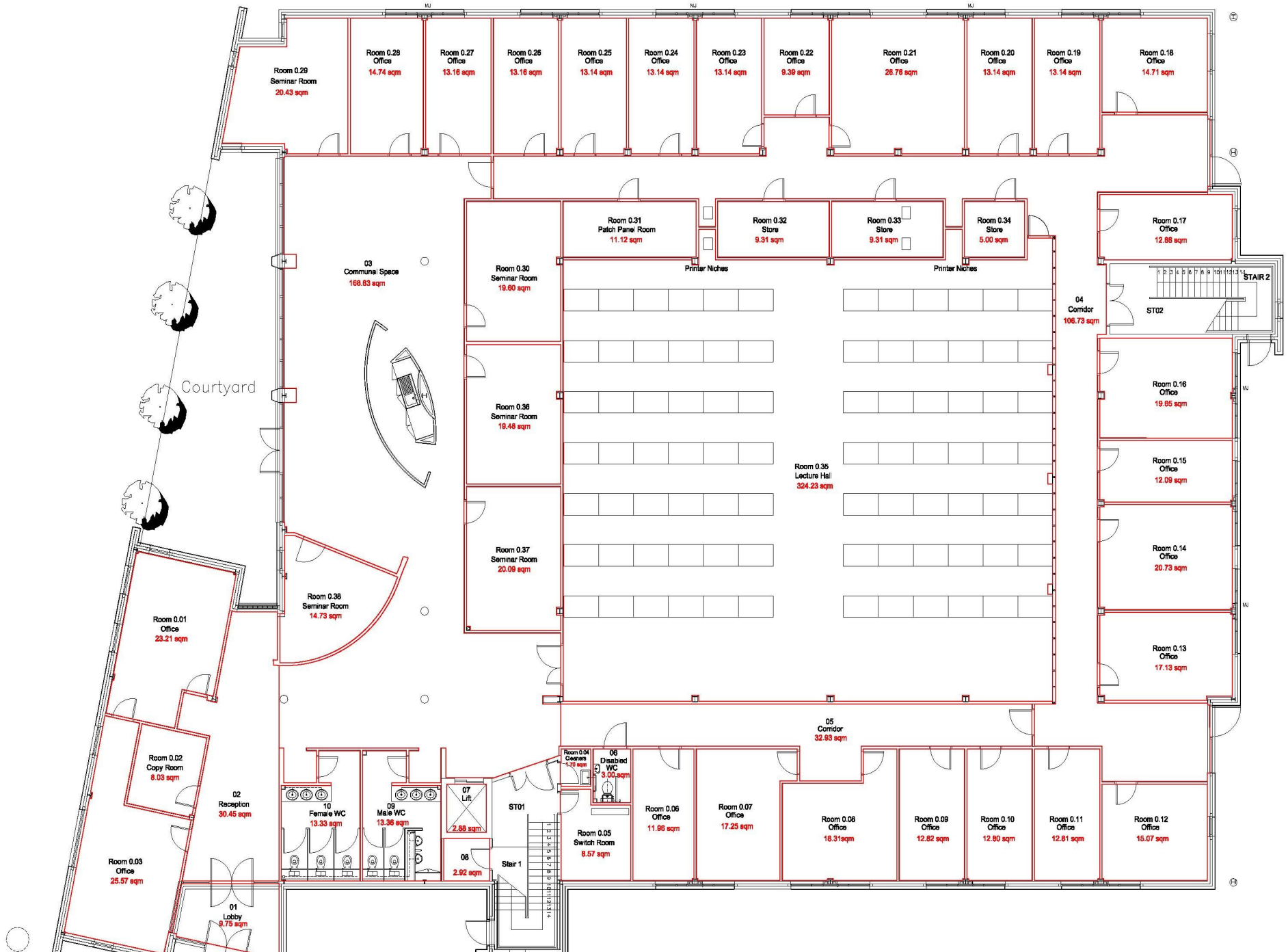

216-A Computer Science

ARCHIBUS/FM Data Transfer

Building Code	Floor Code	Room Code	Room Area	Room Name	Room Usage	Space Category	Unit Code
216-A	00	02	30.45	Reception			
216-A	00	03	168.83	Communal Space			
216-A	00	08	2.92	Store			
216-A	00	RM 0.01	23.21	Office			
216-A	00	RM 0.02	8.03	Copy Room			
216-A	00	RM 0.03	25.57	Office			
216-A	00	RM 0.06	11.96	Office			
216-A	00	RM 0.07	17.25	Office			
216-A	00	RM 0.08	18.31	Office			
216-A	00	RM 0.09	12.82	Office			
216-A	00	RM 0.10	12.80	Office			
216-A	00	RM 0.11	12.81	Office			
216-A	00	RM 0.12	15.07	Office			
216-A	00	RM 0.13	17.13	Office			
216-A	00	RM 0.14	20.73	Office			
216-A	00	RM 0.15	12.09	Office			
216-A	00	RM 0.16	19.65	Office			
216-A	00	RM 0.17	12.88	Office			
216-A	00	RM 0.18	14.71	Office			
216-A	00	RM 0.19	13.14	Office			
216-A	00	RM 0.20	13.14	Office			
216-A	00	RM 0.21	26.76	Office			
216-A	00	RM 0.22	9.39	Office			
216-A	00	RM 0.23	13.14	Office			
216-A	00	RM 0.24	13.14	Office			
216-A	00	RM 0.25	13.14	Office			
216-A	00	RM 0.26	13.16	Office			
216-A	00	RM 0.27	13.16	Office			
216-A	00	RM 0.28	14.74	Office			
216-A	00	RM 0.29	20.43	Seminar Room			
216-A	00	RM 0.30	19.60	Seminar Room			
216-A	00	RM 0.31	11.12	Patch Panel Room			
216-A	00	RM 0.32	9.31	Store			
216-A	00	RM 0.33	9.31	Store			
216-A	00	RM 0.34	5.00	Store			

Questions



Practical Help

- St Andrews fEC webpage
 - www.st-and.ac.uk/finance/RGFO/fec
- Finance
 - Keith Otto ko2@st-and.ac.uk (x2594)
 - Alix Oliver aco1@st-and.ac.uk (x2209)
- Estates
 - fecestates@st-andrews.ac.uk

